

AW050K 17mm Super Stubby Air Impact Wrench

Special Embedded Tie-in Design | 1/2" & 3/8" Anvils Changeable

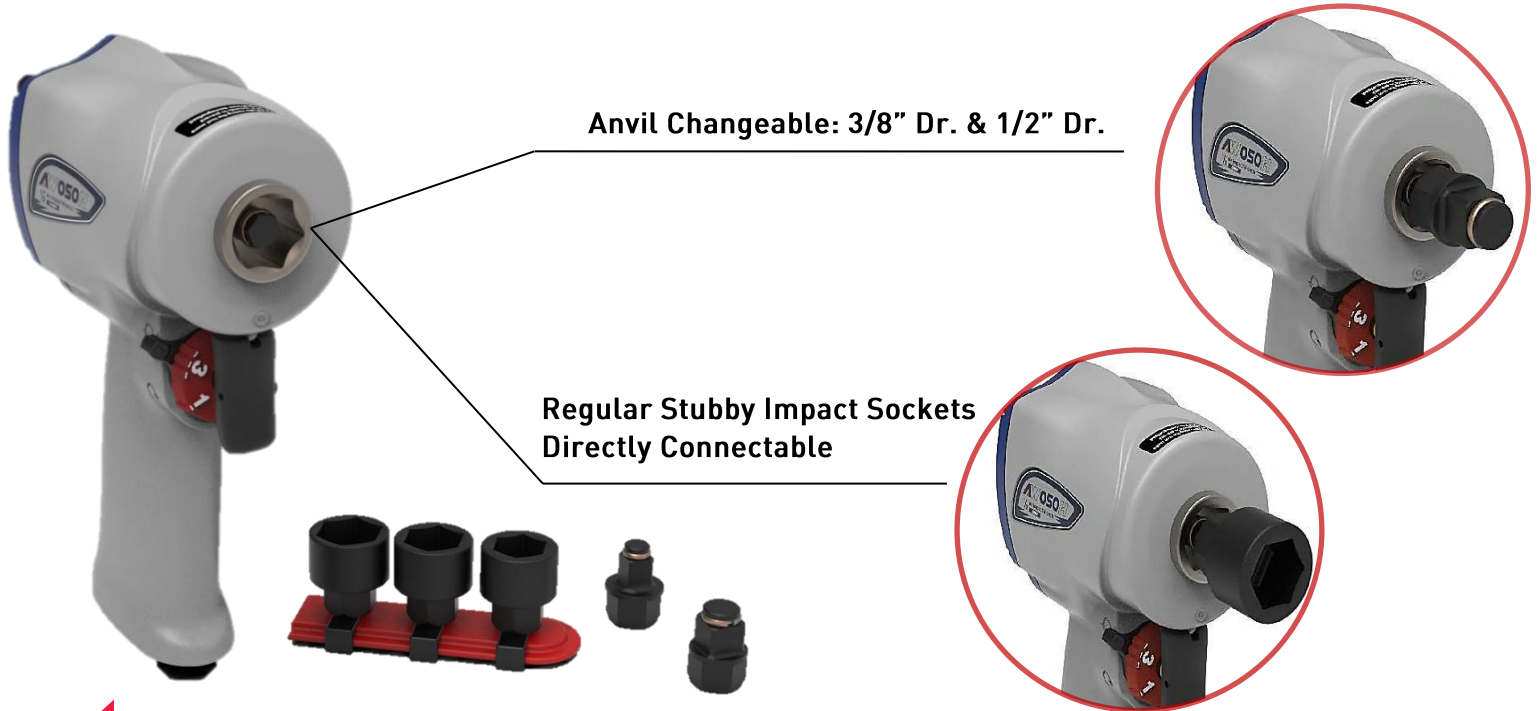

Features

- Mechanism: Jumbo Hammer
- Highest durable Japanese steel anvil
- Handle exhaust
- One hand operation for Forward & Reverse : 3 positions for each side
- Special Tie-in design for multiple functions :
 - Insert and Change 1/2" & 3/8" Anvils Freely
 - Regular Stubby Impact Sockets Directly Connectable

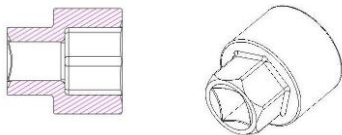

- Short Length: only 3.38" allows to easily access in cramped spaces
- Powerful torque with low noise (muffler option)

Applications



Industry



Agriculture Machine



Motorcycle



Automotive

Specifications

Square Drive	Bolt Capacity	AVG/ Air Con.	Air Inlet	Air Pressure	Hose Size	Working Torque	Max. Torque	Free Speed	Vibration	Sound Pressure	Overall Length	Net Weight
1/2"	5/8" (M16)	4.0CFM (113 L/min)	1/4"	90PSI (6.2Bar)	3/8"	400FT-LB/ 542N.m.	600FT-LB/ 813N.m.	9000 RPM	11.6 m/s ²	96.5 Dba	86mm (3.38")	1.35KG (2.98LB)

APACH INDUSTRIAL CO., LTD.

176 Industrial 9th Rd., Tali Dist., Taichung City, Taiwan

41208 Tel +886 4 2271 2835 Fax +886 4 2271 4840

www.apach-tools.com info@apach.com.tw

